

**ANEXO II
ITEM 1**

ANEXO

REF.: AVENIDA DAS AMÉRICAS, S/Nº (ÁREA DO PAL 33293) - BARRA DA TIJUCA

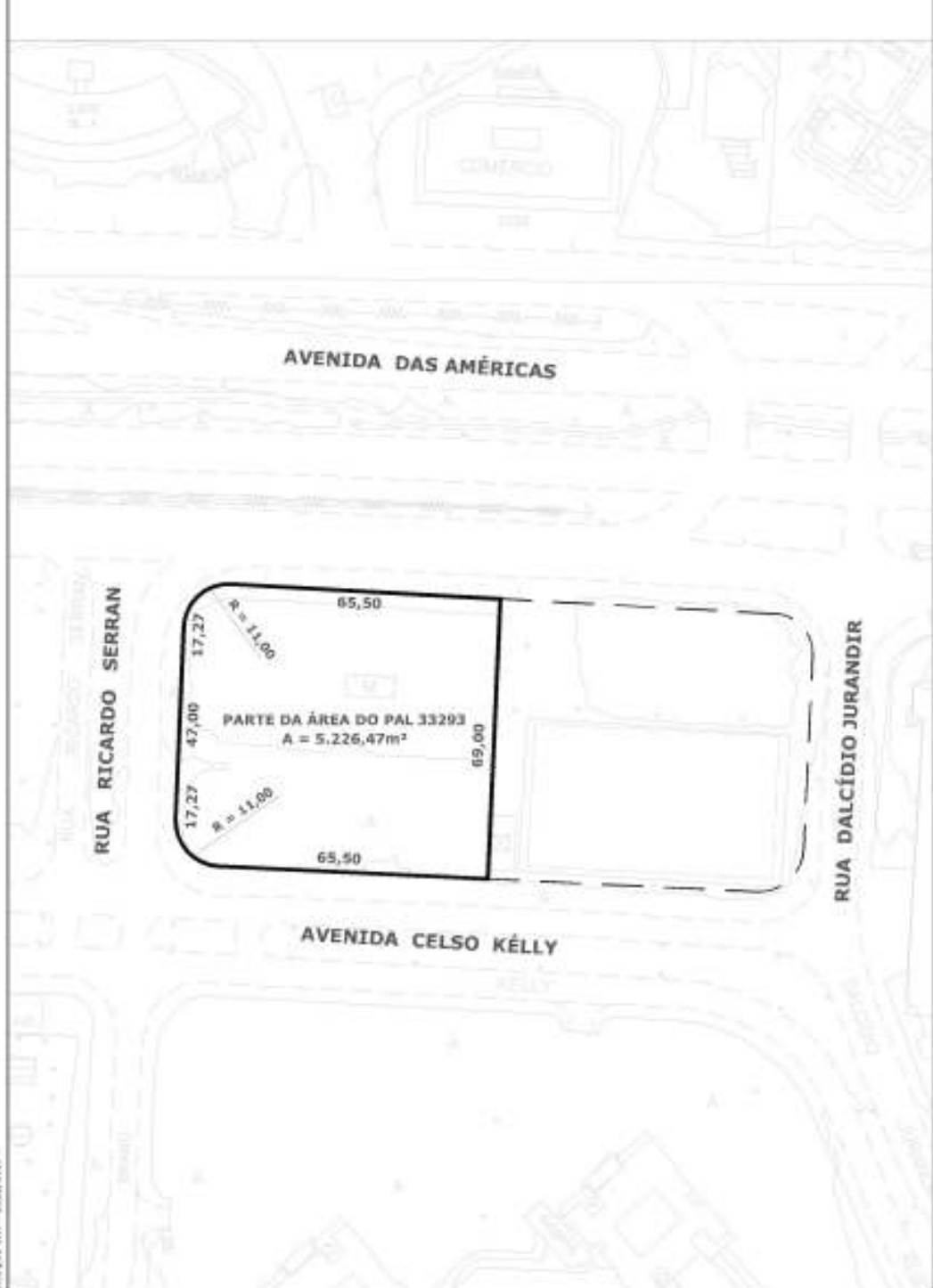

ITEM 2

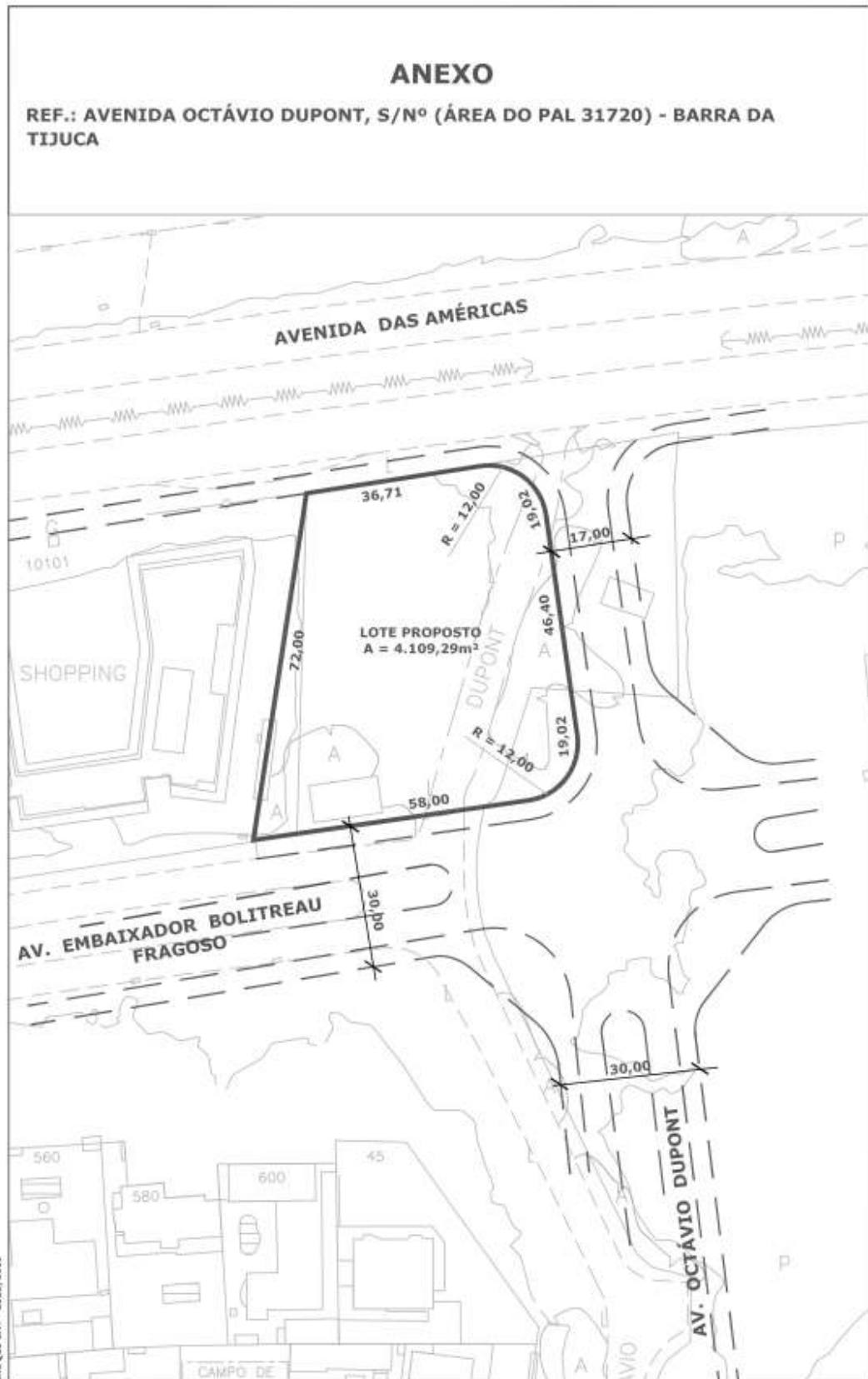

ITEM 3

ANEXO

REF.: SERVIDÃO DE PASSAGEM 4 DO PAA 12.365 (ATUAL RUA WILFRED PENHA BORGES), S/Nº, LOTE DO PAL 48.187 - RECREIO DOS BANDEIRANTES

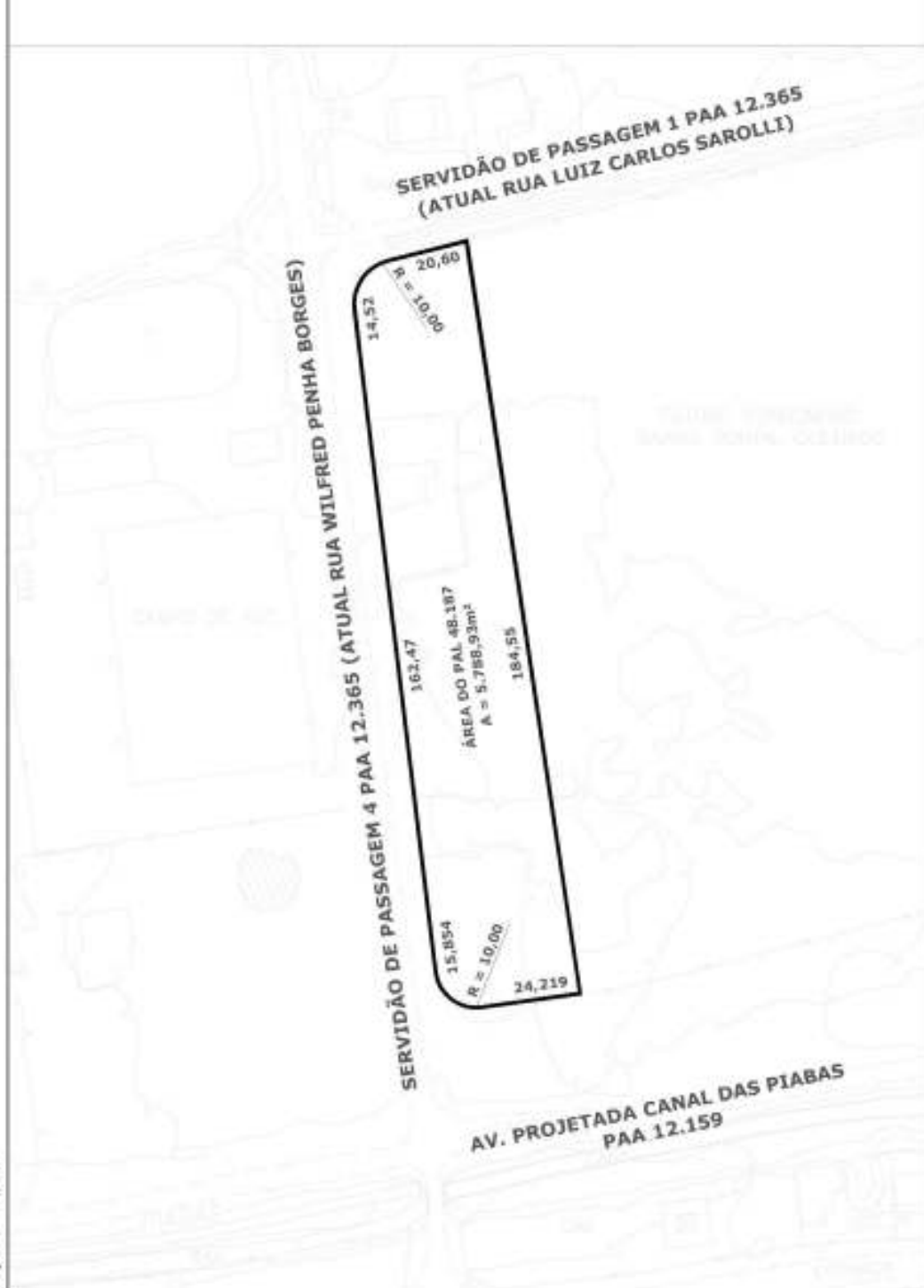

ITEM 4

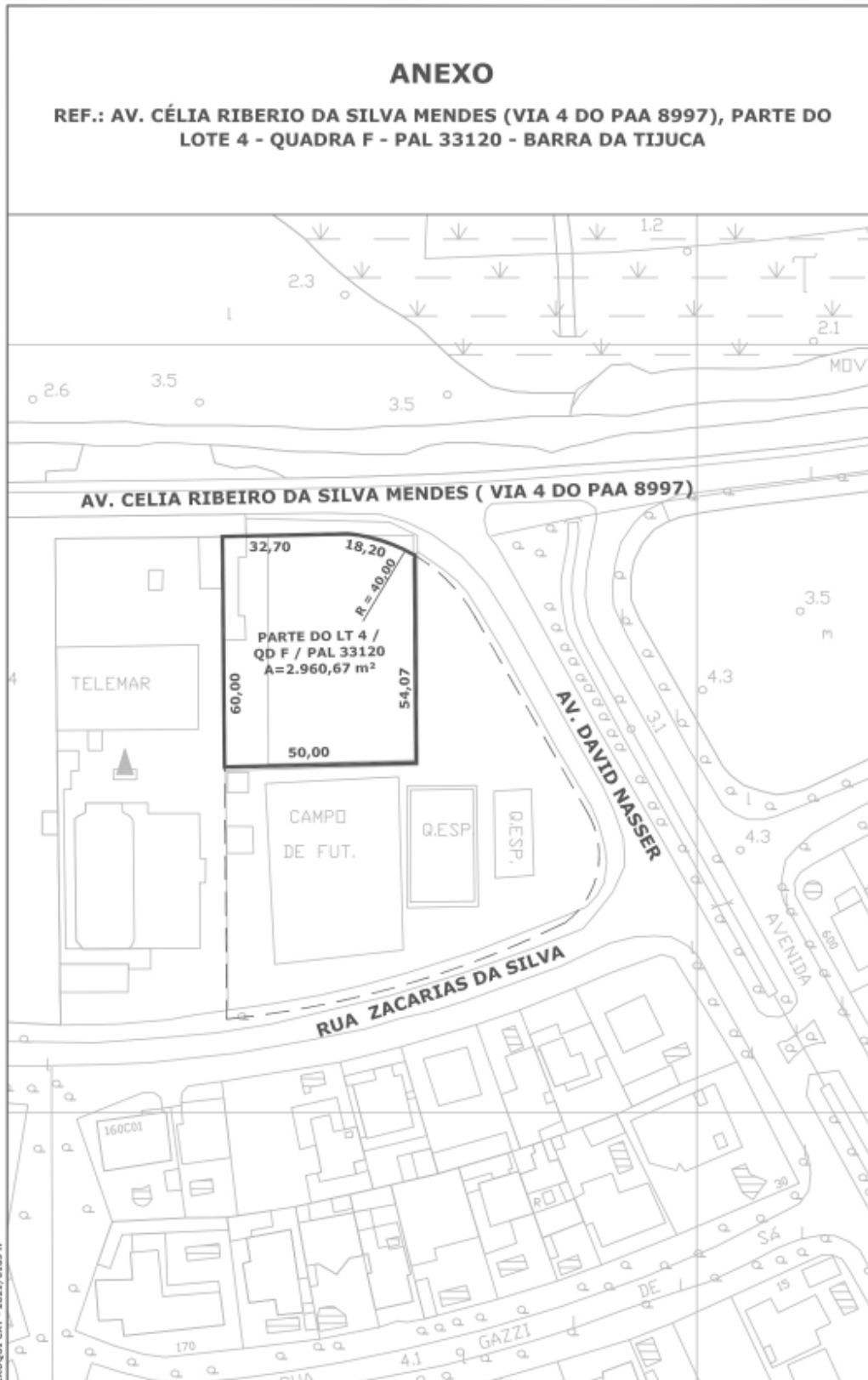

ITEM 5

ANEXO

REF.: AV. DOM HÉLDER CÂMARA, LOTE 2 DO PAL 49.128 - DEL CASTILHO

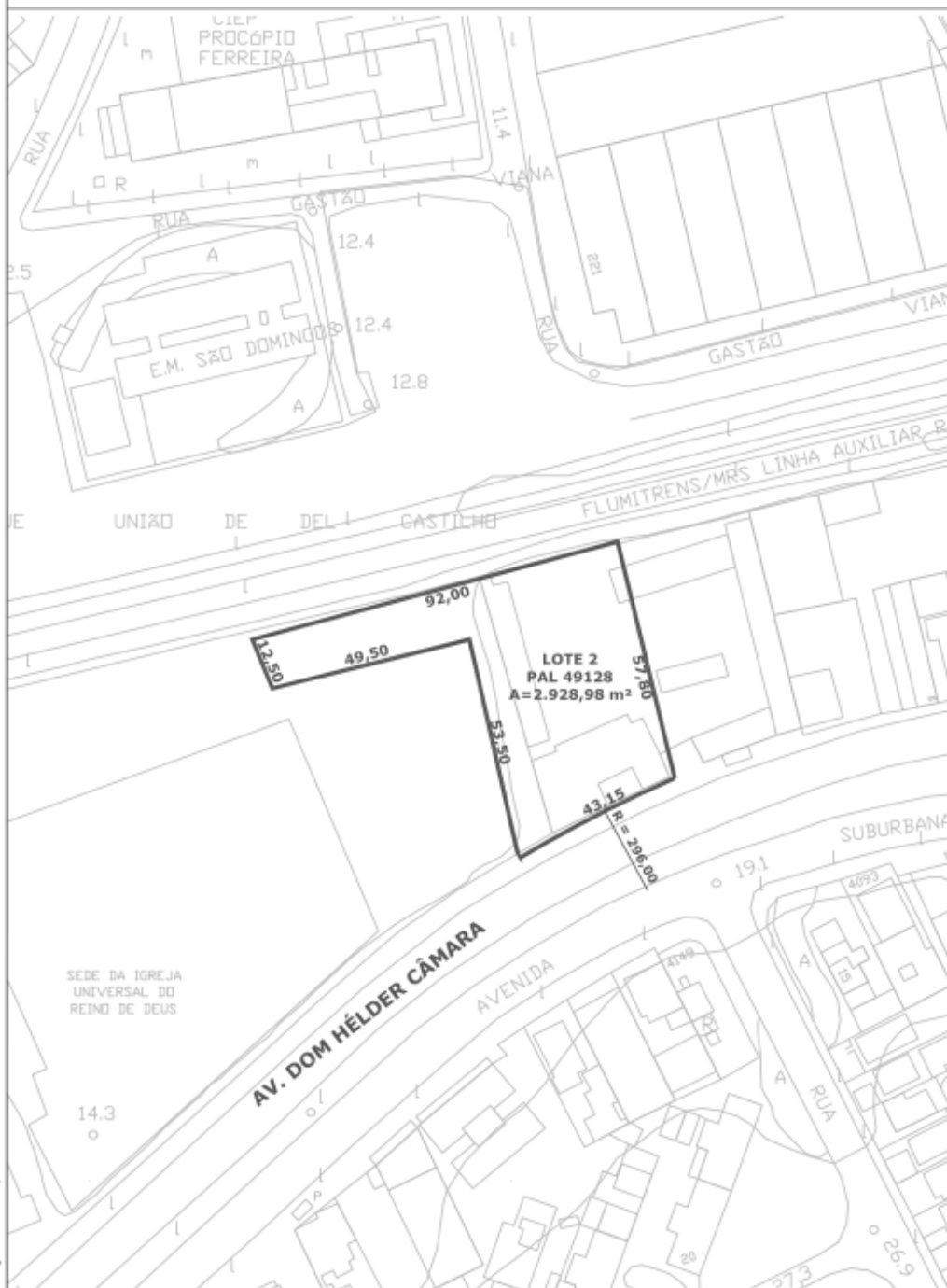

ITEM 6

ANEXO

REF.: RUA DONA MARIANA, Nº 63 - BOTAFOGO

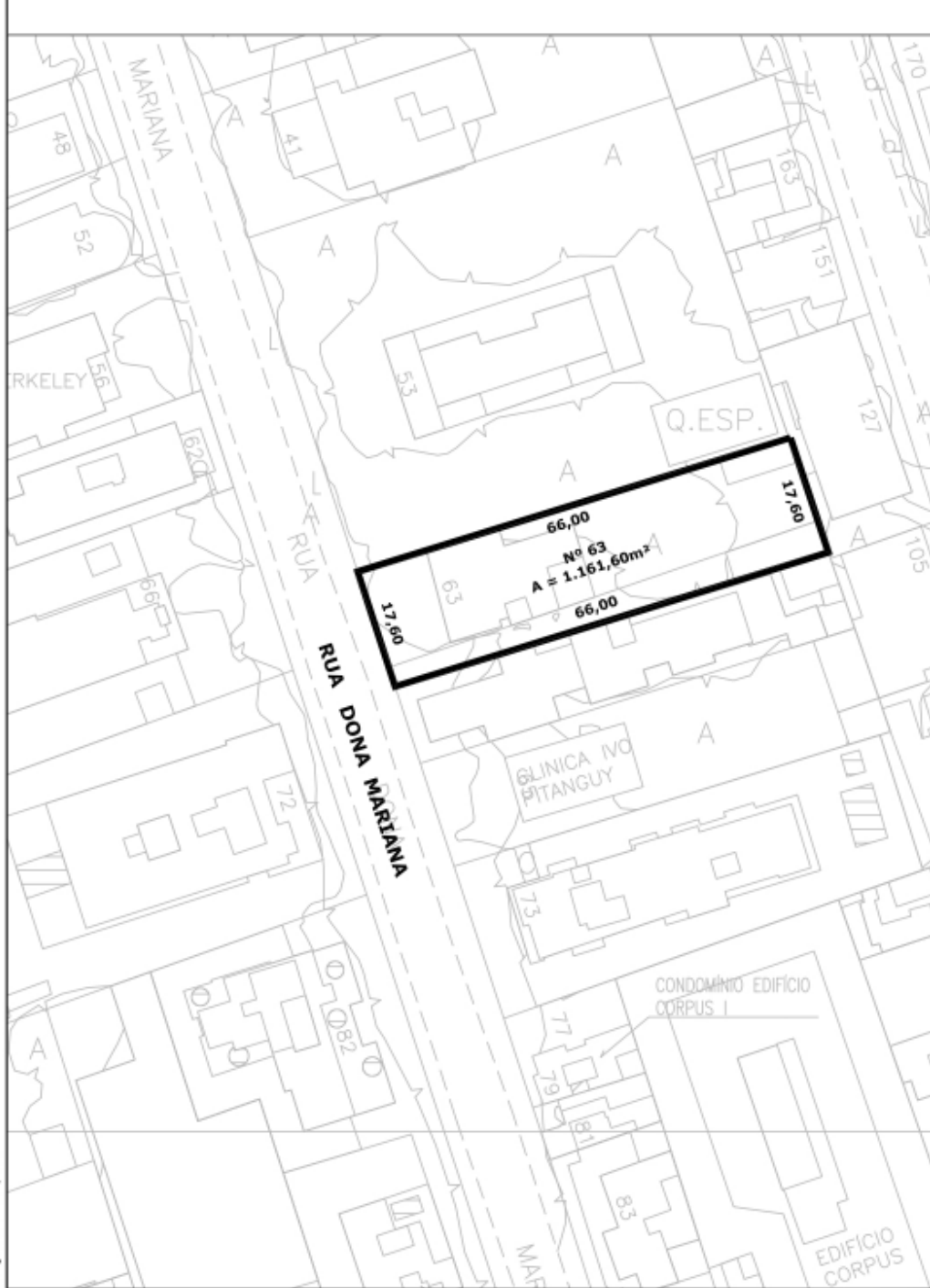

ITEM 7

ANEXO

REF.: RUA BRUNO GIORGI S/Nº - JACAREPAGUÁ - ÁREA COM 5.740,74M² DO PAL 39.024

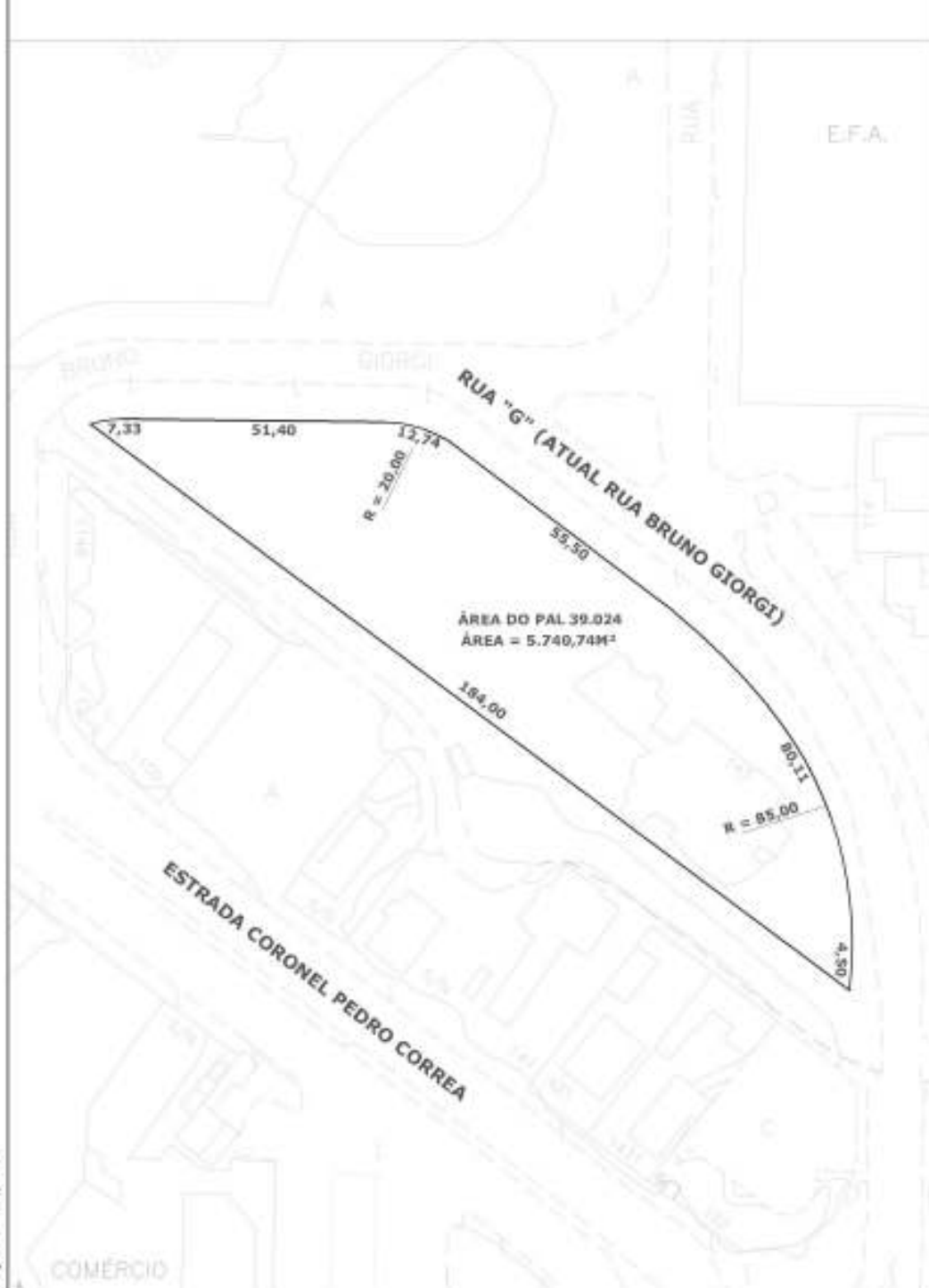

ITEM 8

ANEXO

REF.: AV. SOBRAL PINTO (ANTIGA AV. CANAL DE MARAPENDI), S/Nº
LOTE DO PAL 46.355 - BARRA DA TIJUCA

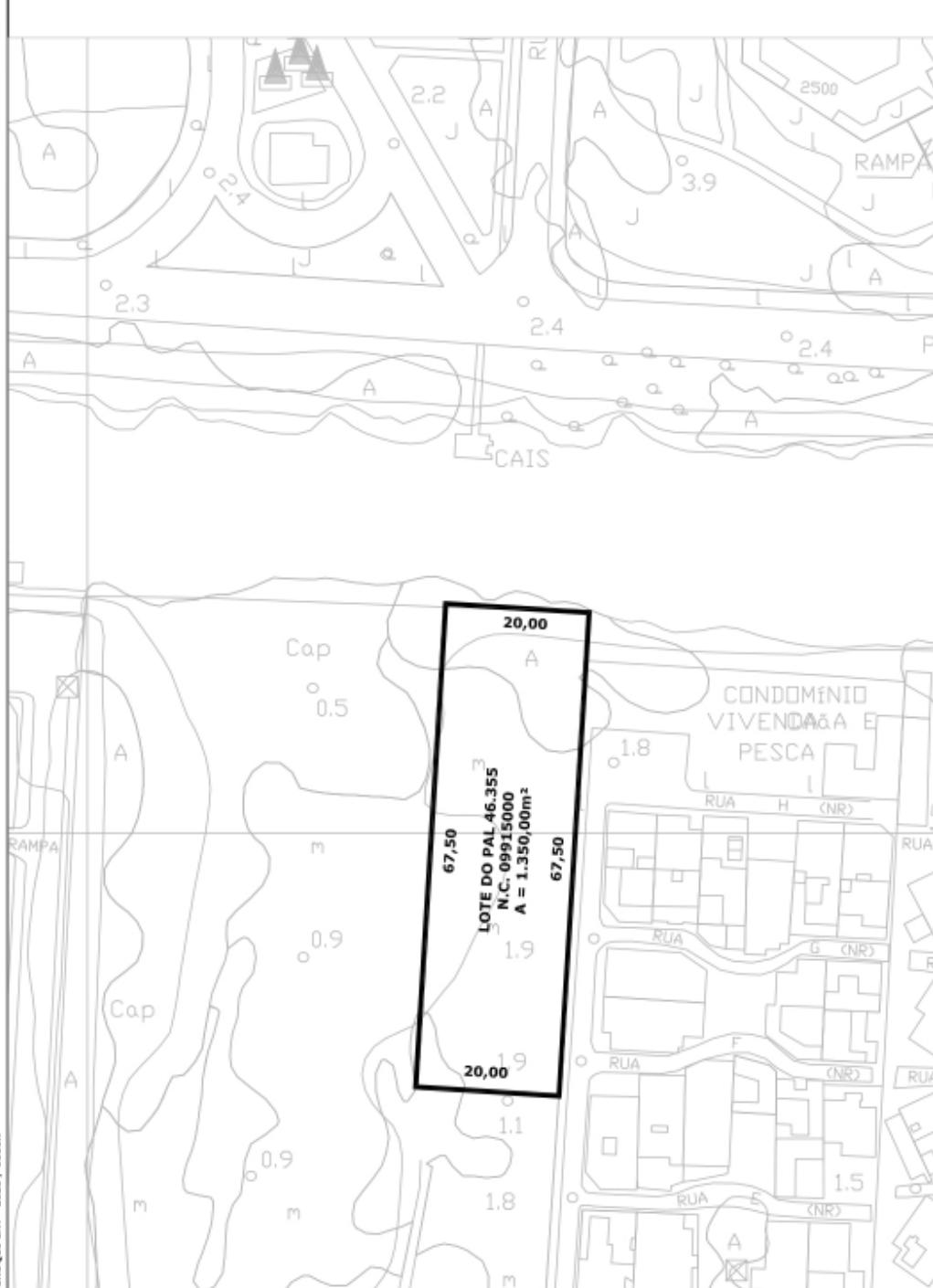

ITEM 9

ANEXO

REF.: RUA ULYSSES GUIMARÃES, LOTE 1 - QD 10 - PAL 48150 - CIDADE NOVA

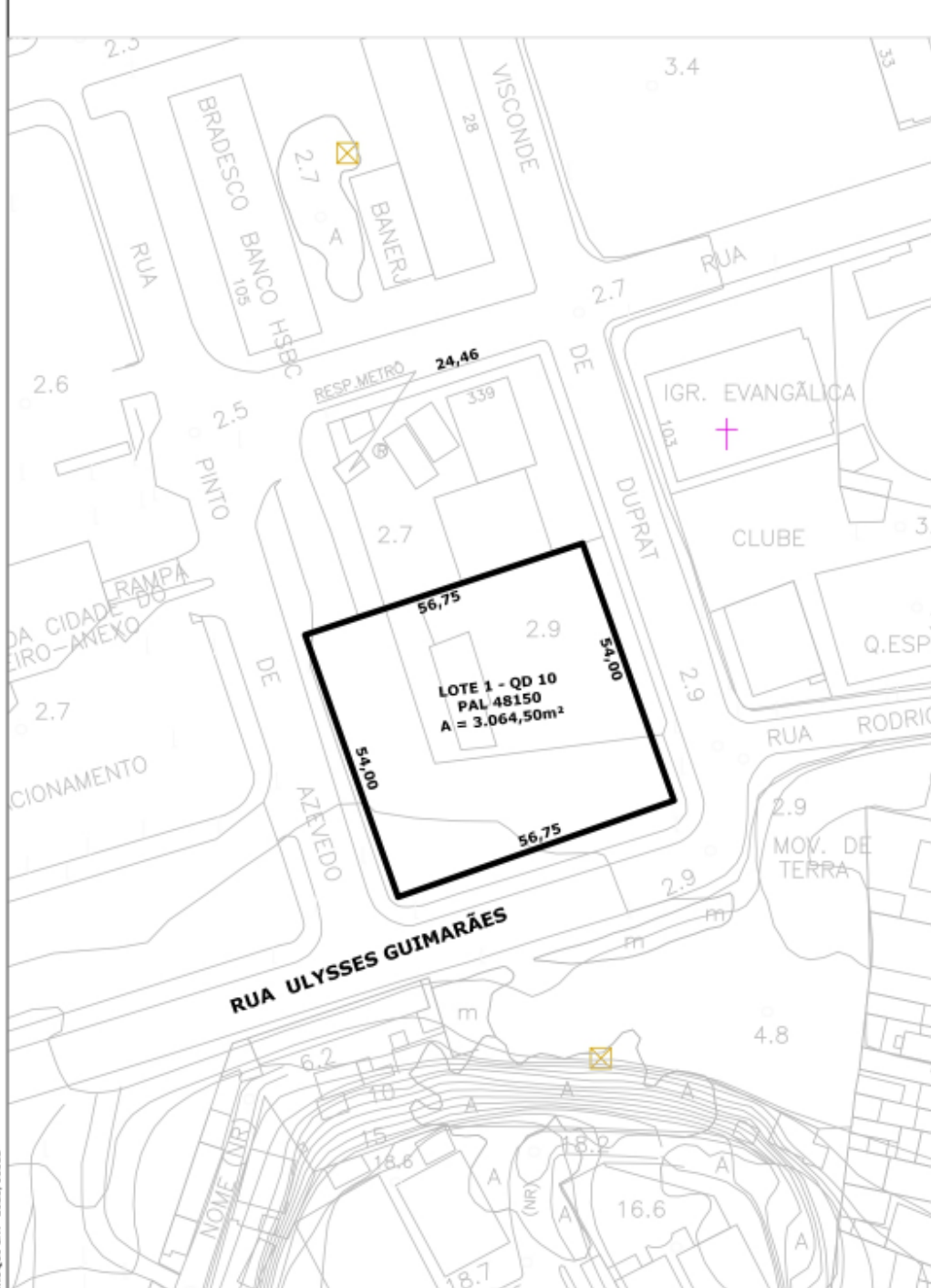

ITEM 10

ANEXO

REF.: MARECHAL HENRIQUE LOTT, SNº (LT DO PAL 49344)
BARRA DA TIJUCA

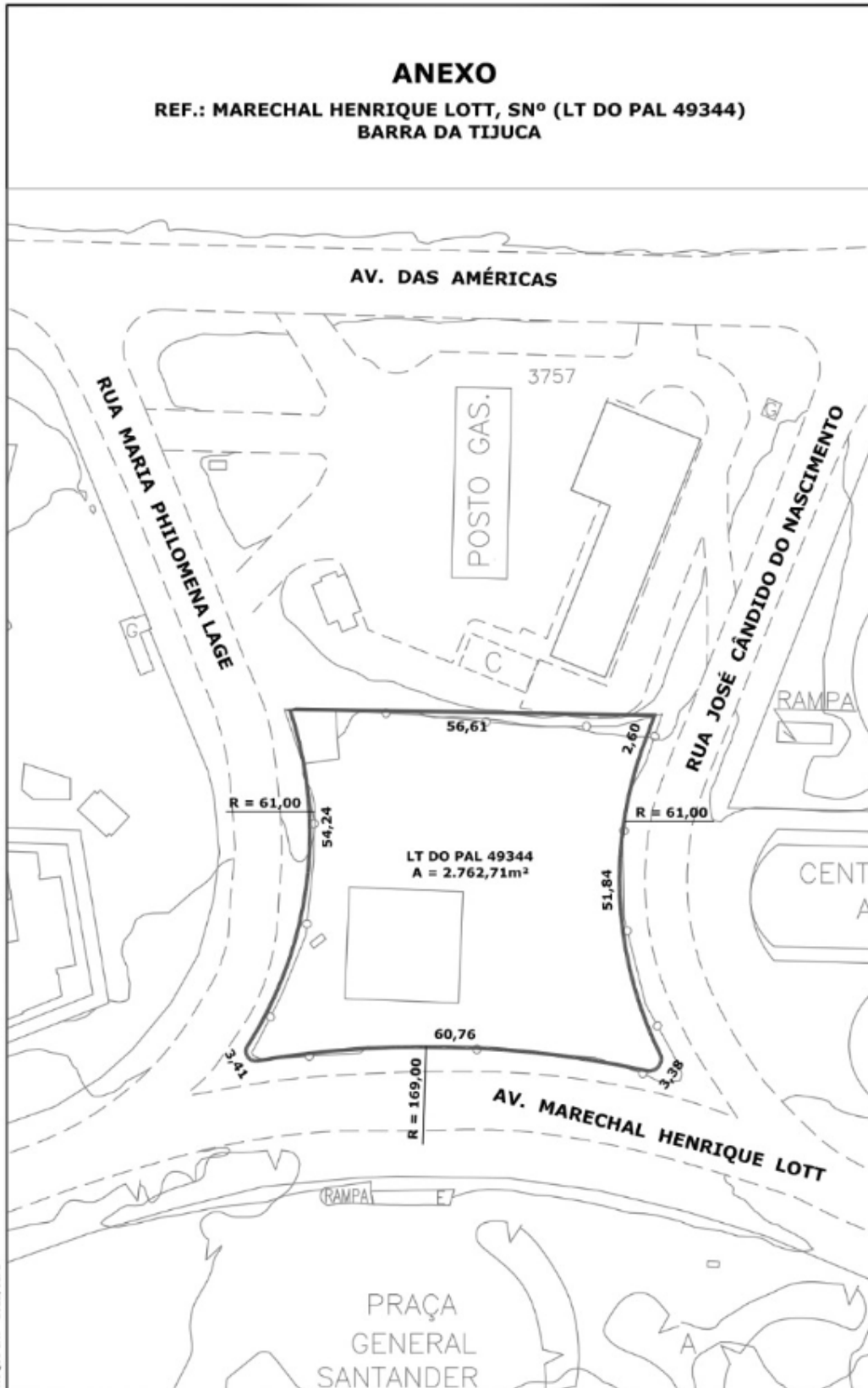

ITEM 11

ANEXO

REF.: AV. ALFREDO BALTHAZAR DA SILVEIRA, Nº 900
RECREIO DOS BANDEIRANTES

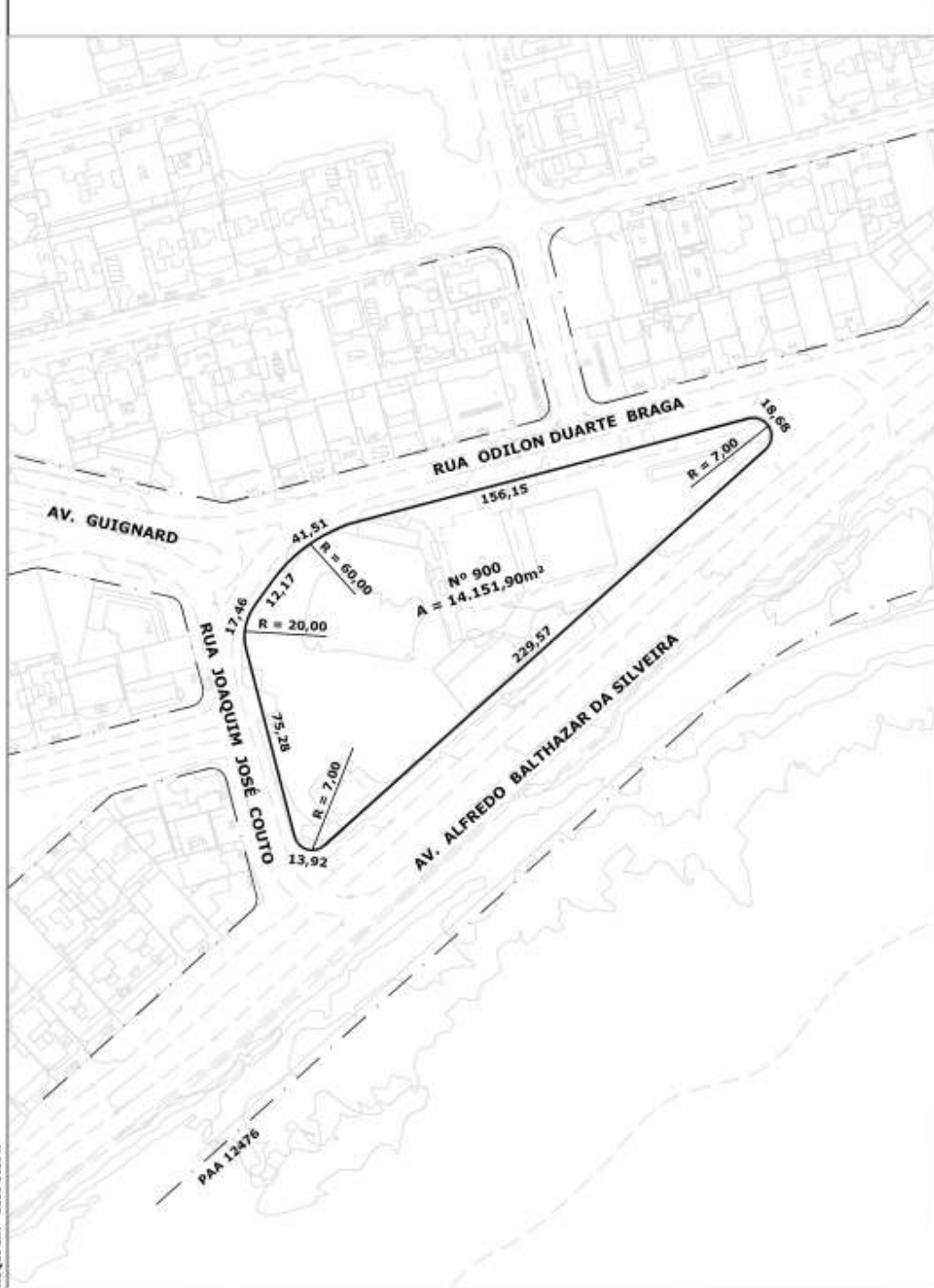

ITEM 12

ANEXO

REF.: AV. BARTOLOMEU MITRE, Nº 1297 - GÁVEA

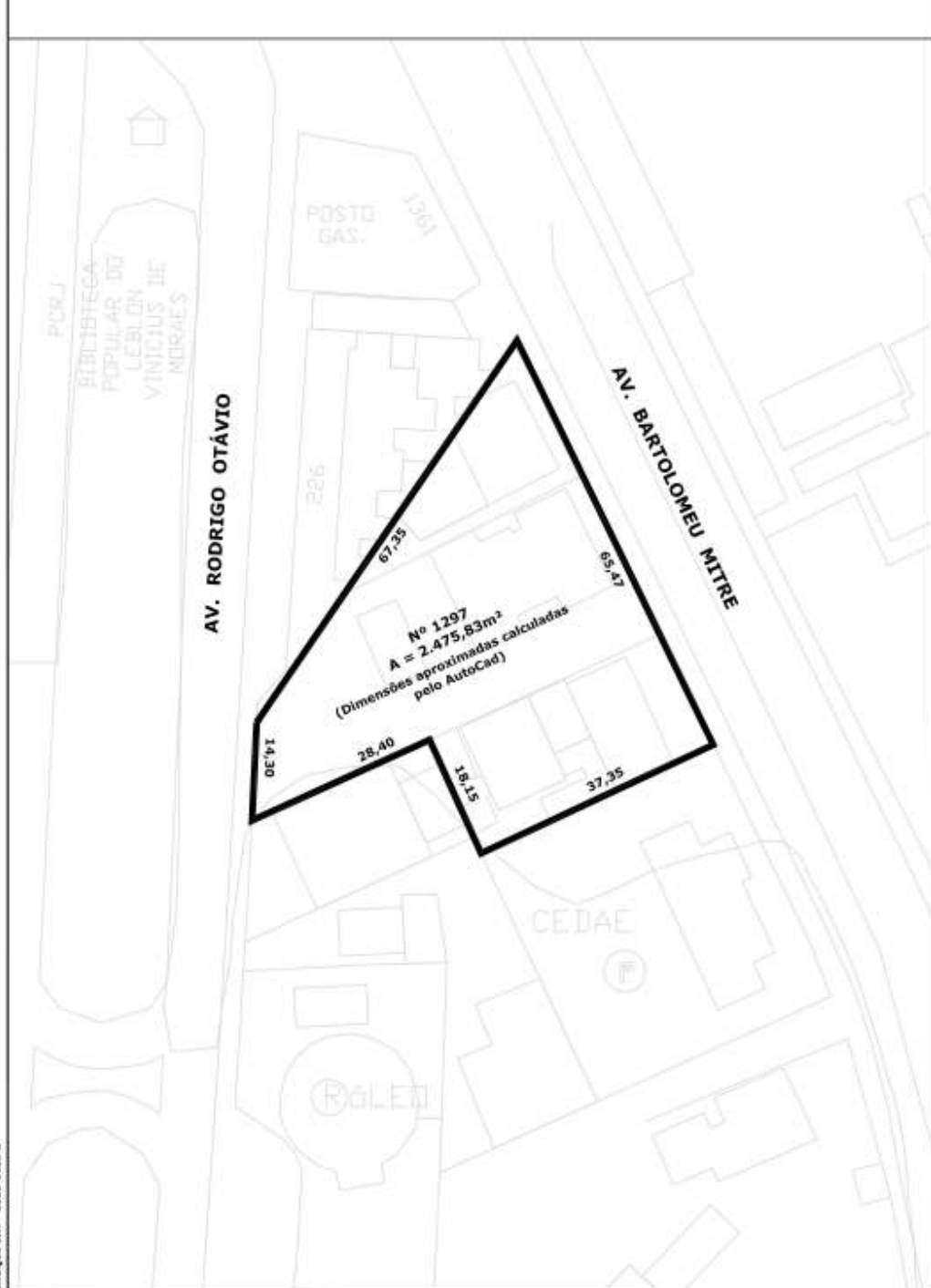

ITEM 13

ANEXO

REF.: AV. ALFREDO BALTHAZAR DA SILVEIRA, ESQUINA COM RUA VITORINO FERNANDES, ÁREA 1.916,00M² DO PAL 32.005, RECREIO DOS BANDEIRANTES

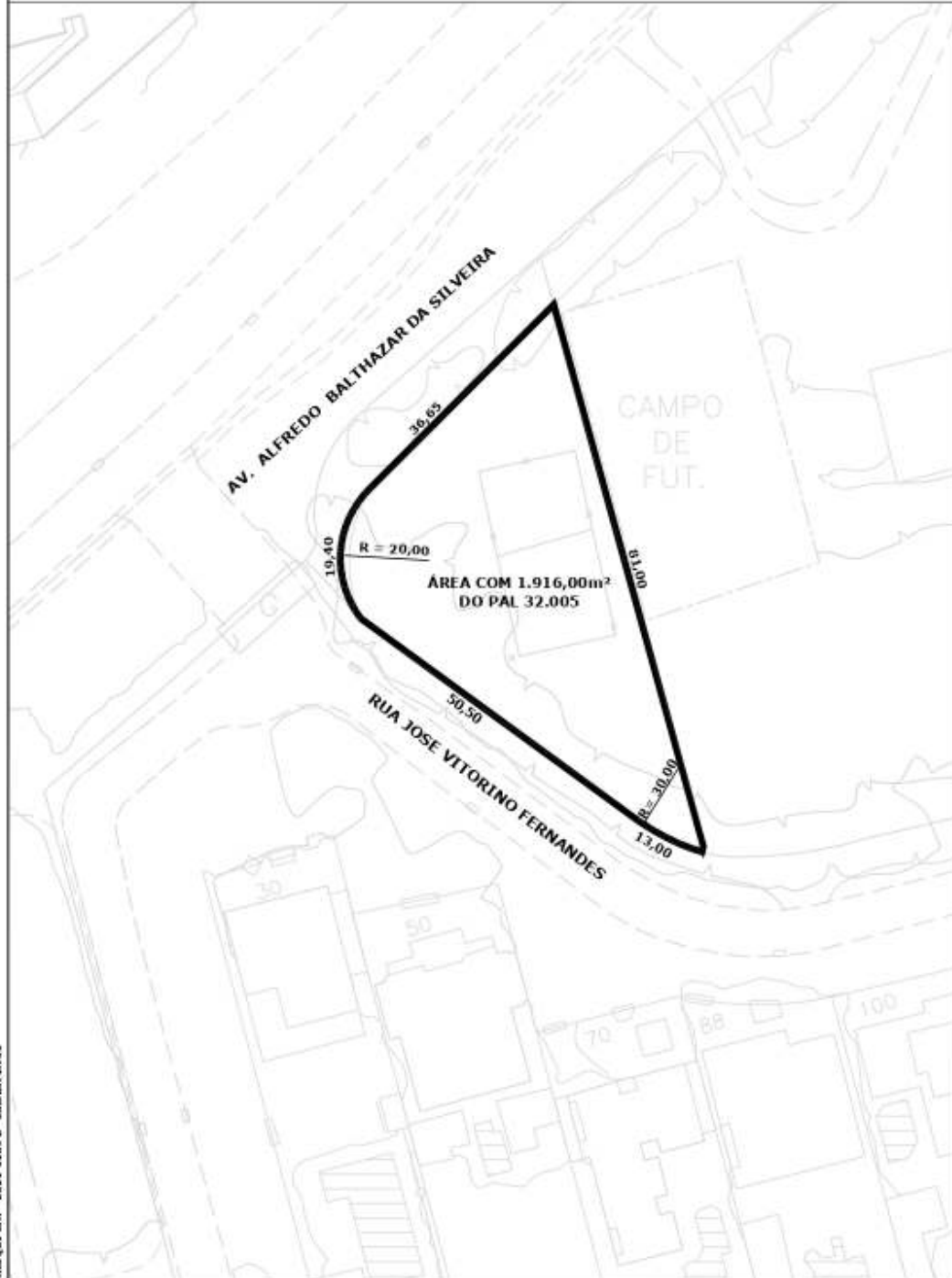

ITEM 17

ANEXO

REF.: RUA RACHEL DE QUEIROZ ESQUINA COM RUA ANTONIO ARTHUR BRAGA -
BARRA DA TIJUCA

